

# BLU/DURATIQUE RANGE

## CLASSIC CYLINDER PULL

Product Code: CP30

LIT-DC-CP30



### *316 Marine Grade Stainless Steel Hardware Range*

- Stunning traditional style back to back euro cylinder pull
- Bolt-through fixings from the inside to prevent removal from the outside
- Extremely high quality and long lasting performance
- To suit door thickness up to 60mm
- Ideal for use where corrosion levels are high, such as coastal environments and in acidic timber
- Manufactured from 316 Marine Grade Stainless Steel
- Lifetime guarantee for finishes SSS, PSS, MSB, PSB & PPB
- 25 year guarantee for Duratique finish TMB



# COASTAL

*Shaping the future.*

Front Profile

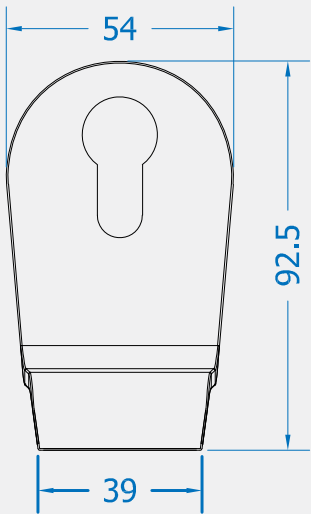

Side Profile

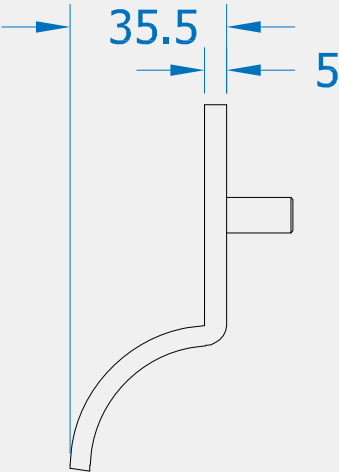

Visit [www.coastal-group.com](http://www.coastal-group.com) for CAD drawings

BLU  
FINISHES:



SSS  
Satin Stainless Steel



PSS  
Polished Stainless Steel



PPB  
Polished Brass - PVD  
Stainless Steel



PSB  
PVD Satin Brass



MSB  
Matt Smooth Black

DURATIQUE  
FINISHES:



TMB  
Textured Matt Black

PART NUMBER	PRODUCT DESCRIPTION	FINISH	UNITS
CP30-SSS	Back to back euro cylinder pull	SSS	Set
CP30-PSS	Back to back euro cylinder pull	PSS	Set
CP30-PPB	Back to back euro cylinder pull	PPB	Set
CP30-PSB	Back to back euro cylinder pull	PSB	Set
CP30-MSB	Back to back euro cylinder pull	MSB	Set
CP30-TMB	Back to back euro cylinder pull	TMB	Set



COASTAL  
*Shaping the future.*